



SHAHID BUILDERS (PVT.) LTD
Engineers & Contractors



**COMPANY
PROFILE**

www.shahidbuilders.com.pk

SBL FOOTPRINT



SHAHID BUILDERS (PVT.) LTD
Engineers & Contractors

NO'S OF
PROJECTS
100+

NO'S OF
STAFF
200+

NO'S OF
MACHINERY
80+

AVERAGE
TURNOVER
1,100M+



ABOUT US

**“ Specialized Construction,
Unparalleled Quality ”**



The history of Shahid Builders stretches back to 1985. Over the period of 30 years, the company has undertaken many challenging projects initiating itself from the construction of housing units to the construction of residential and non-residential buildings, high end hospitals, highways, Clubs, farm lands and parks.

The company successfully addresses the current challenges and aims to work for the future developments at national and international level.

Shahid Builders with its head office located in Pakistan has successfully opened its new branch office in the Sultanate of Oman. The Company's aim is to represent itself and its country globally and to serve the requirements of the people and be part of building a better world.

Nevertheless, it is committed to provide the best quality construction through its most valuable manpower and through modern constructional tools and equipment's.

GROUP OF COMPANIES



CASAREINA





CEO MESSAGE

Driven by a vision to make a positive impact, I embarked on an entrepreneurial journey in 1985. This journey led to the creation of Shahid Builders (Pvt.) Ltd., a company dedicated to delivering exceptional value and exceeding client expectations in the construction industry.

As CEO, I am committed to fostering a team that is strategically led and focused on achieving our goals. My passion lies in providing quality living solutions, which has been the cornerstone of Shahid Builders since its inception.

Years of experience in the industry have exposed me to innovative construction methods and sustainable practices employed globally. I believe that adopting these techniques is crucial to minimizing human error and ensuring the highest quality standards in our projects.

Mian Shahid Mehmood

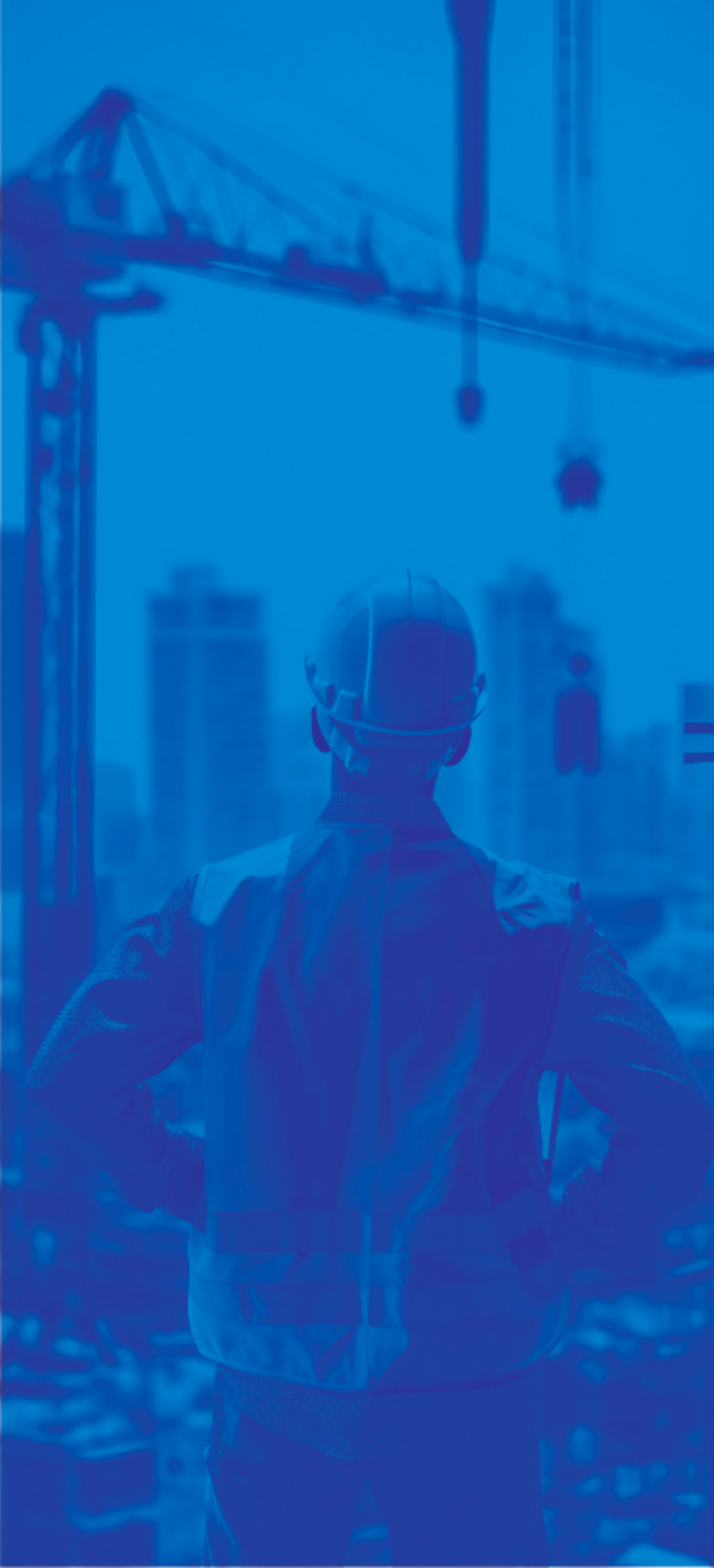

VISION & MISSION

Empowering Dreams, Shaping Landscapes: Pioneering the Future of Construction Excellence by delivering innovative, sustainable and iconic projects that inspire communities and stand the test of time.

We envision a world where our expertise transforms visions into reality, setting new benchmarks in quality, efficiency and client satisfaction.





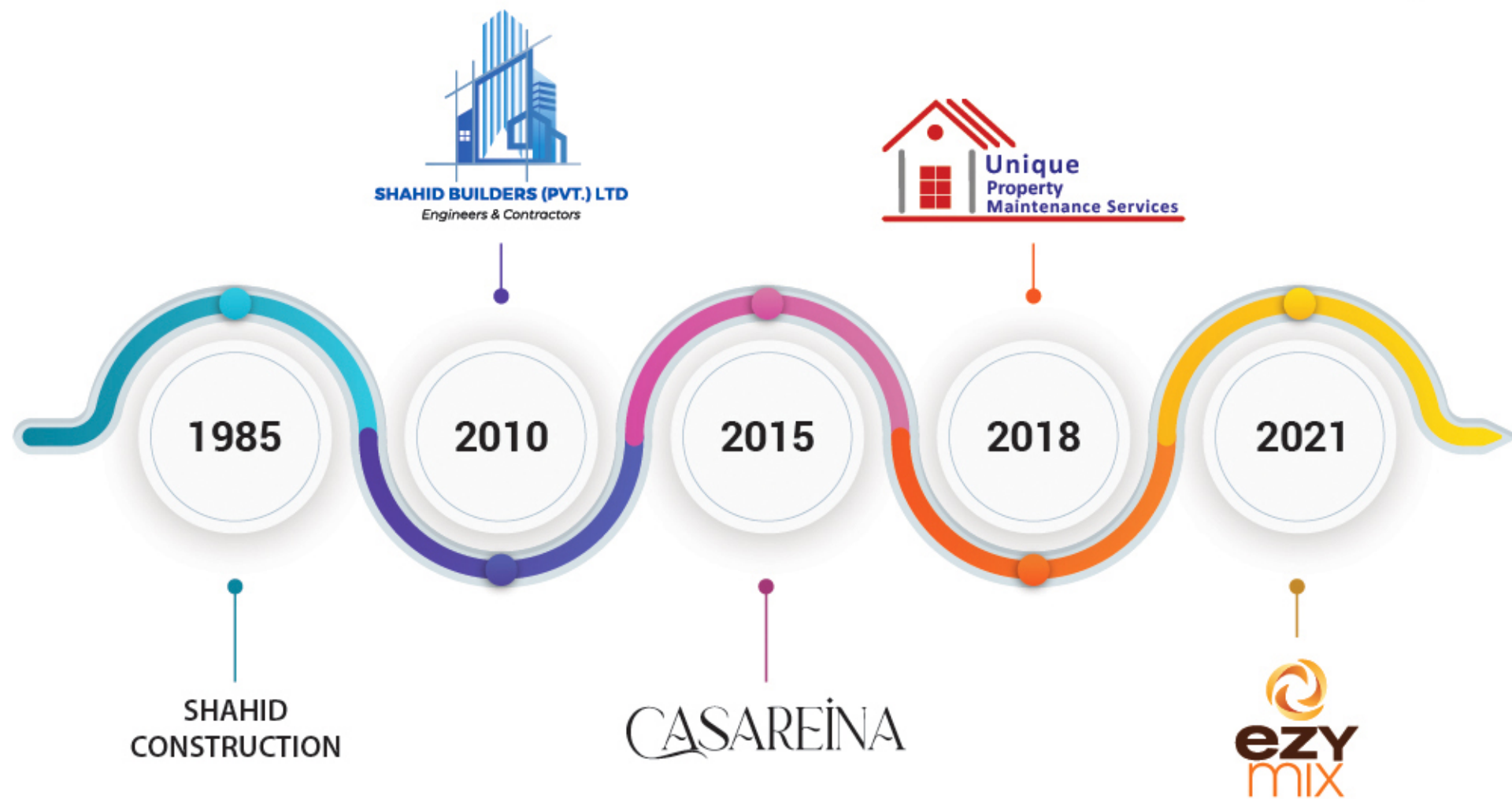

OUR SERVICES

Our clients benefit from a diverse range of services that we offer. We actively engage in special projects for our clients and willingly go above and beyond, as our main goal is to ensure their complete satisfaction, no matter the effort required. In order to provide the utmost assistance to our clients, we offer the following services:

- Civil Works
- Electrical Works
- Highways & Roadworks
- HVAC Works
- Plumbing Works
- Finishing Works
- Construction of Bridges & Underpasses
- Mechanical Works



LIST OF PLANT & MACHINERY

Sr #	Description	No's	Sr #	Description	No's
01	Concrete Batching Plant	4	13	Vibrator Engine	12
02	Concrete Pump	3	14	Concrete Mixer Machine	17
03	Lift Hoist	2	15	Concrete Lift Machine	17
04	Tower Crane	1	16	Lift Tower	88
05	Dumper Truck	6	17	Float Machine	3
06	Wheel Loader	2	18	Welding Plants	10
07	Front Loader of Tractor	2	19	Water Pump	36
08	Transit Mixer	4	20	Power Generator	12
09	Steel Cutting Bending Machine	2	21	Water Bowser	4
10	Air Compressor Mobile	12	22	Concrete Bucket	8
11	Plate Compector	4	23	Form Work (Sft)	143190
12	Baby Road Roller	2	24	Scaffolding Pipes (Rft)	161656



CERTIFICATES

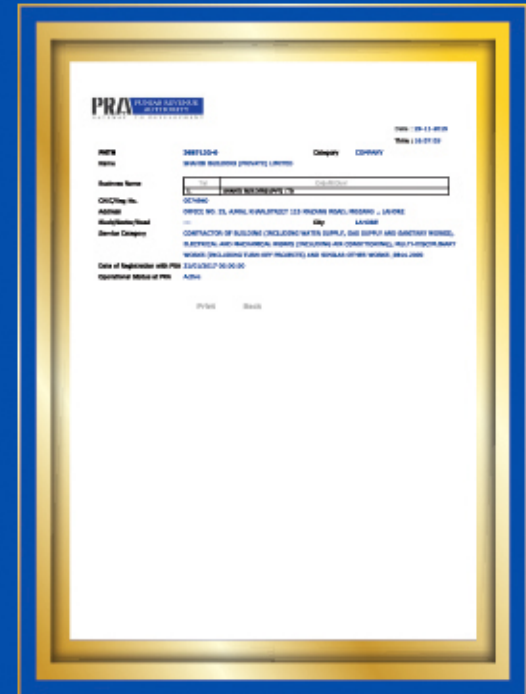

REGISTERED WITH



OUR CLIENTS

We are proud of our ongoing projects and collaborations with noteworthy organizations and institutions of Pakistan. Our vision is to become the leading construction services provider in Pakistan and become a globally recognized and trusted entity.



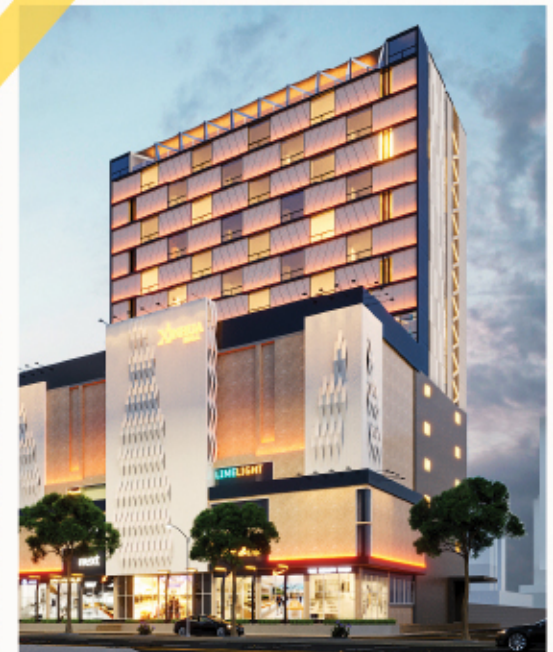

LIST OF ONGOING PROJECTS

Sr #	Particulars of Project	Client Name	Consultant/ Architect	Project Start Date	Project Finish Date	Project Cost	Client Address
01	Construction of Lifestyle Residency apartments Tower No. 6 comprising of (B+G+7) and Tower No. 5 comprising of (B+G+9) Lahore	FGEHA	EA Consultant	Dec-21	Sep-24	2,759 M	FGEHA Office Islamabad
02	Construction of High Rise Tower No. 02 (B+G+17) Comprising 72 X Ctype Flats (4 X Flats on Each Floor) At NRC E-8 Islamabad (Phase-I, B+G+8 Only)	MES NAVY	MES NAVY	Mar-23	Mar-25	995 M	Headquarters Director of Works & Chief Engineer (NAVY) Sector E-8 Islamabad
03	Construction of Grand Entrance Building No. 3 DHA Quetta, Balochistan	DHA Quetta	R-Chitect	Jan-20	Apr-24	1000M	DHA Quetta Airport Road
04	Construction of 120 Rooms Residential Building for Friendship at FFP Site Wah Bchran	WASO	WASO	Mar-22	Mar-24	900 M	WASO Office Islamabad
05	Construction of 2- Bed Apartments (Block 11-20) Under Package-8 at Kuchlaq Road, Quetta	PHA	EA Consultant	Aug-20	Sep-24	547 M	Naya Pakistan Kuchlaq Road Quetta
06	Construction of OPD/Ward Block at GINUM (Phase-II), Gujranwala	WASO	WASO	Apr-18	Apr-24	550 M	WASO Office Islamabad
07	Construction of Over Head Water Tank, Pump-Rooms & Deep well Turbines Near Mianwali	WASO	WASO	May-23	May-24	161 M	WASO Office Islamabad
08	Construction of Structural Works of Studio Corporate Offices (Xinhua Mall)	Xinhua Mall	Xinhua Mall	Feb-23	Apr-24	350 M	Xinhua Mall Gulberg Lahore
09	Construction / Development Of 5-Marlas 85 No Of Houses At Zamin City	CASA Venture	CASA Venture	Feb-21	Apr-24	428 M	22E/II Gulberg III Lahore
10	MES Gwadar Cantt Multiple projects	MES	MES	Apr-22	May-24	770 M	MES Gwadar Cantt



COMPLETED PROJECTS IN LAST 10 YEARS

Sr #	Particulars of Project	Project Start Date	Project Finish Date	Project Cost	Client Address
01	Construction of OPD, Complex at MH Rawalpindi B+G+5	Sep-11	Jan-14	1921 M	Near Flashman Hotel Muree Road Rawalpindi
02	Construction of Revamping of District Head Quarter & Tehsil Head Quarter Hospital Package 4 B+G+2	May-17	May-19	1156 M	50 B-3 Gulberg III Lahore
03	Construction of Family Wing Hospital 500 Beds at Sarfaraz Rafique Road, Lahore Cantt	Aug-18	Jul-23	989 M	DHA Quetta Airport Road
04	Construction of New Academic Block at Ghulam Ishaq Khan Institute of Engineering Sciences and Technology B+G+3	May-17	Feb-20	885 M	534-Street 33 E11/3, Islamabad
05	Construction of Apartments Building Consist of Two Basement, G+6, at 22-E/II Gulberg III, Lahore 2B+G+6	Aug-16	Sep-18	751 M	22E/II Gulberg III Lahore
06	Construction of GC Mess at 4th Pak Bn PMA Kakul Abbottabad	Jun-15	Sep-16	445 M	Near Flashman Hotel Muree Road Rawalpindi
07	Construction of Officer's Family Block at MH Rawalpindi	Nov-12	May-15	700 M	Near Flashman Hotel Muree Road Rawalpindi
08	Construction of Mental Health Deptt at MH Rawalpindi	Dec-13	Dec-16	560 M	Near Flashman Hotel Muree Road Rawalpindi
09	Construction of Polo Club & Park at Military Farm Lands Lahore	May-16	Mar-17	509 M	ACE 4 Corps 163 Munir Road Lahore Cantt
10	Construction of 48 x D-Type Flats (G+3) Block 1,2,3,4,5, & 6 at Roomi Park, Rawalpindi G+3	May-14	Mar-16	443 M	Near Flashman Hotel Muree Road Rawalpindi
11	Const. of 32 x C Type (G+3) Flats at Eqpt Yd Ckl, Rwp G+3	Jan-13	Jun-15	276 M	Near Flashman Hotel Muree Road Rawalpindi
12	Construction of Bank of Khyber at Peshawar	May-16	May-18	248 M	The Mall State Life Building Peshawar



COMPLETED PROJECTS IN LAST 10 YEARS



Sr #	Particulars of Project	Project Start Date	Project Finish Date	Project Cost	Client Address
13	Construction of Oncology Department CMH Lahore Cantt	May-19	Jun-21	260 M	GHQ, E in C's Branch (DP & W) Rawalpindi.
14	Construction of Academic Block No. 1 NUST School of Health Sciences at, Sec H-12, Islamabad.	Oct-13	Jan-15	240 M	Scholars Avenue Sector H-12 Islamabad
15	Construction of Learning Alliance School DHA Campus Phase-VIII Lahore	Aug-10	Aug-12	231 M	32/1 J Block DHA Phase VIII Lahore
16	Construction of 48 x E-Type Flats (G+3) Block 5 ,6, 7, 8, 9 & 10 at Lahore Cantt G+3	May-14	Jul-15	214 M	Near Flashman Hotel Muree Road Rawalpindi
17	Construction of Nab Headquarters Building at G-5/2, Islamabad G+4	Feb-16	Aug-17	198 M	Central Civil Division Sitara Market Pak PWD Islamabad
18	Construction of Admin Block House, Abbottabad	Oct-15	Jun-16	159 M	Near Flashman Hotel Muree Road Rawalpindi
19	Construction of Admin Block, Al-Aleem Medical College, Gulab Devi Chest Hospital, Lahore	Mar-19	Nov-20	128 M	Gulab Devi Hospital Lahore
20	Construction of CSD Shop Quetta	Sep-20	Dec-21	117 M	CSD Rawalpindi
21	Construction of 36 x E Type Flats (T/S) at PMAD Colony Nazimabad, Lahore	May-17	Feb-22	172 M	GHQ, E in C's Branch (DP & W) Rawalpindi
22	Extension Work of CSD Shop Quetta (Main)	Aug-21	Dec-22	79 M	CSD Rawalpindi
23	Construction of the Trust School Aamir Town Harbanspura Lahore	Feb-21	Jun-22	262 M	Fazia Colony Lahore







SHAHID BUILDERS (PVT.) LTD
Engineers & Contractors

 22-E/2, Gulberg III, Lahore - Pakistan.
 +92 42 3577 4301, 3577 4304
 info@shahidbuilders.com.pk
 www.shahidbuilders.com.pk